

Welcome!

Entry Task:

1. Log in to **Naviance**

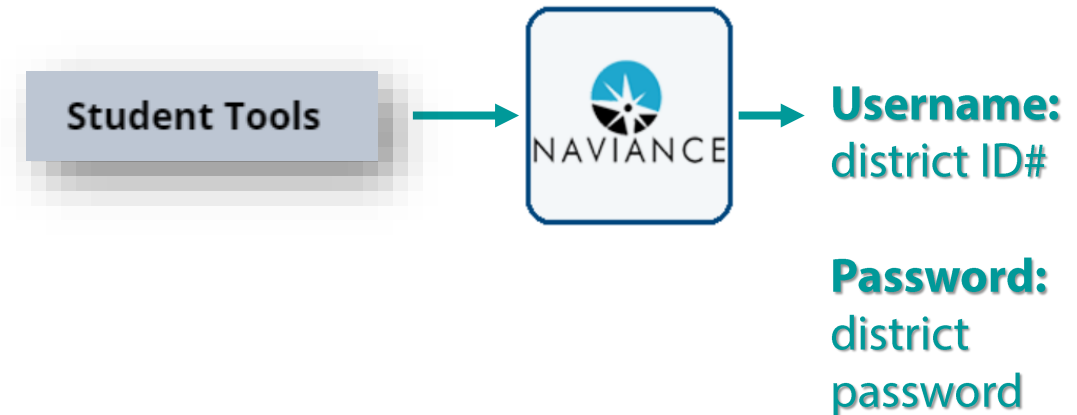

Warm up: *Think about a really unique job that someone has. Have you ever wondered how they got that job?*

EXPLORING CAREERS

Naviance Student

EXPLORING CAREER OPTIONS

Explore Careers and Clusters

In Naviance *Student* there are several ways to explore different types of careers that match your interests.

The **Cluster Finder** survey will help you discover **careers and pathways** you may be interested in.

Taking Cluster Finder

Click **START** to begin selecting **activities**, **personal qualities**, and **school subjects** that you like now or are interested in doing in the future.

Career Cluster Finder

STEP 1 — STEP 2 — STEP 3

Intro Profile Questions View Results

Find career clusters that match your interests and personal qualities.

The Career Cluster Finder will help you learn what career clusters may be a good match for you based on activities that interest you, personal qualities that you have and subjects that you enjoy studying in school.

You'll answer questions about:

1. Activities
Select activities you enjoy doing now and would like to do in the future.
2. Personal Qualities
Select personal qualities that best describe you.
3. School Subjects
Select subjects you enjoy studying in school.

That's it! Based on your answers, we'll show you the list of the top clusters that are likely to be a good match for you.

START

Cluster Finder Results

Upon completion of the survey, your top **three** career clusters will appear.

Click the  icon next to the career cluster to add it your favorites.

If you want to explore other career clusters click **Show more**.

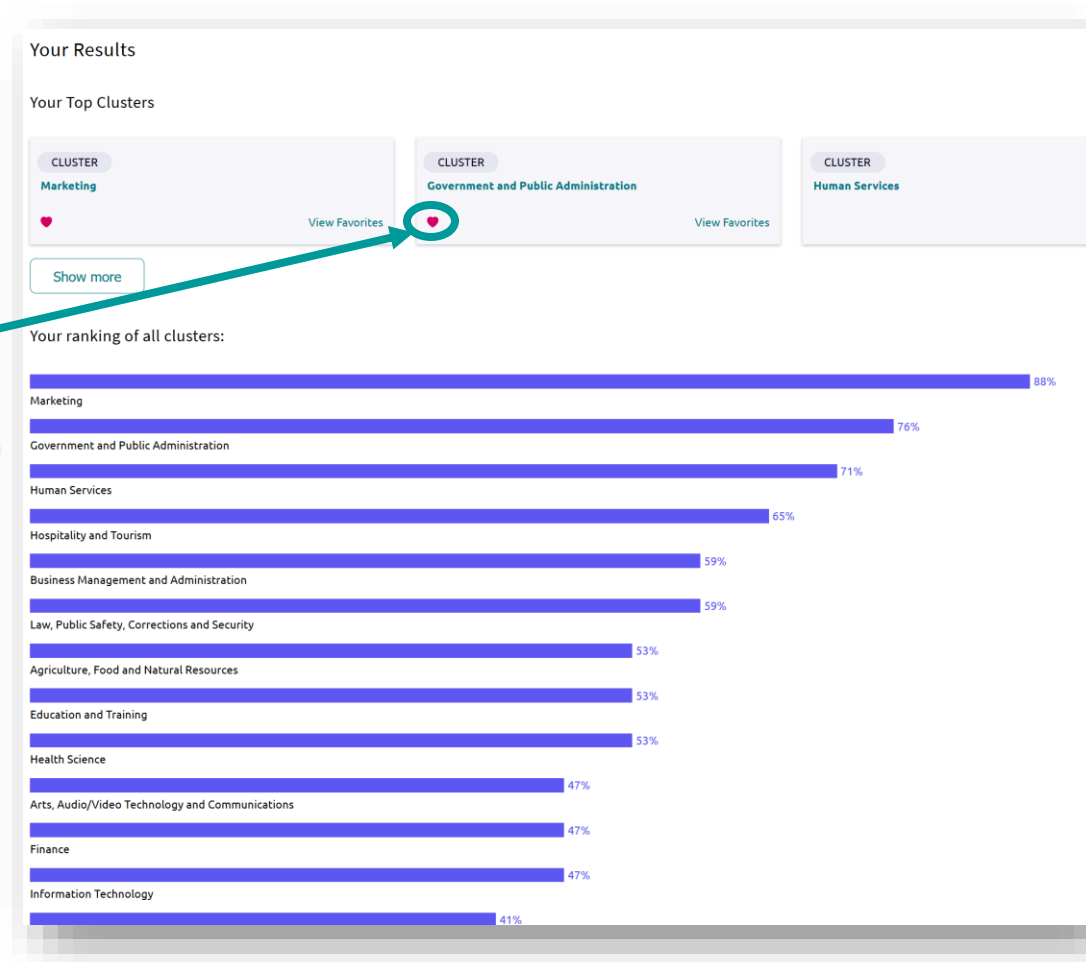

COMPLETE THE LESSON...

Complete the Lesson Task...

To complete the lesson, click **My Planner** > **Tasks** > **Tasks you Need to Work on**. Click the title of the task to **Complete Career Cluster Finder** then click the link to begin.

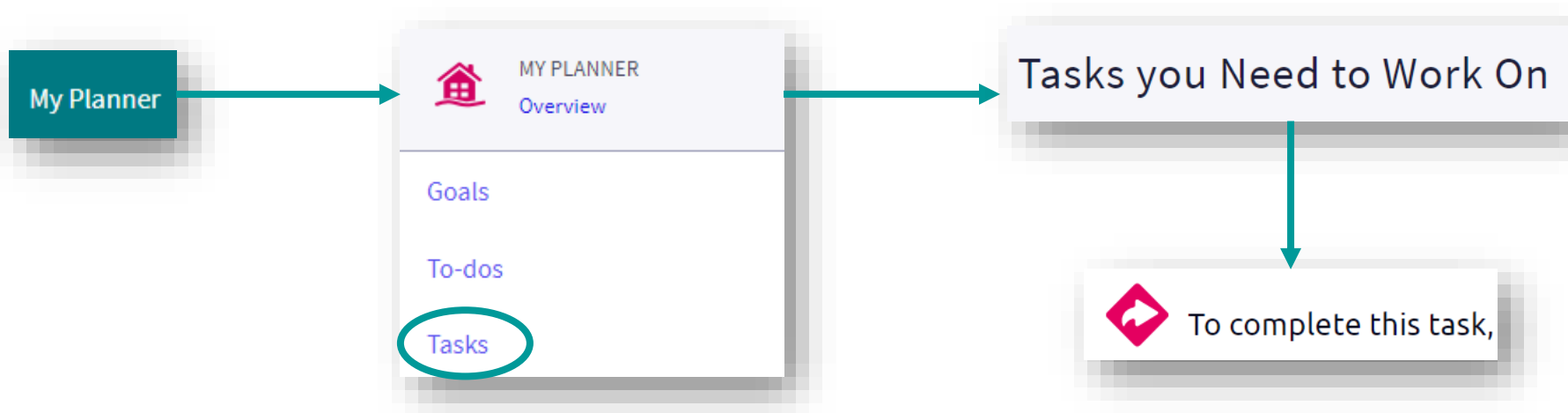

Naviance Questions?

If you have any questions, please contact naviance@everettsd.org.

Be sure to provide your name and school.

To check messages sent to you through Naviance *Student*, login and click the icon for your **messages** in the upper-right corner.

